

45 Joanne Cross Street Lot 39 DPS 17385 Section Block

ROTORUA DISTRICT COUNCIL

Drainage to sewer (5770)



BC

Owner: D. ~~Sycamore~~ *HAYES phone 31521.*

Plumber:

Extra money being paid.

Drainlayer: H. Thompson

Valuation No.: 655/947

Permit No.: 3783

Appn. No.: 945

Date: 15/6/81

INSPECTIONS

Date

Application No. 945.

ROTORUA DISTRICT COUNCIL

Valuation No. 655/947

APPLICATION FOR PERMIT TO CARRY OUT SANITARY PLUMBING AND DRAINAGE WORK

I, the undersigned, hereby apply for permission to have the work described herein, and set out on the plans attached hereto, carried out in accordance with the provisions of the Drainage and Plumbing Regulations 1978 at premises situated at:

Address 45 JONNIE CRES. ROTORUA

Legal Description:

Lot No. 39 Deposited Plan No. 17385

Section No. Block No.

Description of Work: SEWERAGE CONNECTION.

Name and address of person for whom work is to be carried out:

D.R. STAMORE

Name and address of Registered Plumber:

Name and address of Registered Drainlayer: H G THOMPSON.

57 MOUNTAIN RD ROTORUA.

	Value	Fees
Plumbing	\$:	\$:
Drainage	\$ 50 :-	\$ 10 :-
TOTAL FEES		\$ 10 :-

Signature: D. C. STAMORE

Date: 15-6-81.

FOR OFFICE USE ONLY

Receipt Number 4193

Fee Paid 100

Date Paid 15.6.81

Issue Approved [Signature]

Date Approved 15.6.81

Permit No. 3783

Date Issued

See reverse for Fees and Notes

FOR OFFICE USE ONLY

FEES PAYABLE ON THE ISSUE OF ANY PLUMBING OR DRAINAGE PERMIT

according to the Estimated Value of Work

Value of work (excluding value of fittings)		
Value of Work		Permit Fee
Up to	\$50	\$10
\$51 -	\$100	\$15
\$101 -	\$200	\$25
\$201 -	\$300	\$30
\$301 -	\$400	\$35
\$401 -	\$500	\$40
\$501 -	\$600	\$45
\$601 -	\$700	\$50
\$701 -	\$800	\$55
\$801 -	\$900	\$60
\$901 -	\$1000	\$65

\$1001 and over, \$5 extra for every \$200 or part thereof in excess of \$1000

IMPORTANT

INSPECTION & TESTING REQUIREMENTS

DRAINAGE WORK: Drainlayers are required to notify the Plumbing and Drainage Inspector when all work is completed. This includes effluent disposal systems for septic tanks. All drains will be tested with a 1.5m head of water. To implement this test it will be necessary for persons undertaking drainage work to have sufficient drain plugs to fill all sections of the drain prior to the Plumbing and Drainage Inspector arriving on the job, also to have available a stand pipe to apply the 1.5m head pressure.

This form of testing is essential to exclude the possibility of ground water infiltration with its attendant increase in pumping charges and overloading of the sewers and treatment plant.

PLUMBING WORK: Plumbers are required to notify the Plumbing and Drainage Inspector when work is ready for inspection as follows:

- (a) When the building has been initially piped out and wastes are installed (before wall linings are fixed and floors laid).
- (b) When work is complete.

Plans of Drainage and Plumbing Work

In the case of single houses a preliminary drainage plan will not be required. In all other cases, however, plans of the preliminary proposal are to be submitted at the time of application for a permit. In all instances, however, an "as laid" plan must be available on site as a prerequisite to a test of the work.

In commercial buildings full plans and elevations of plumbing stacks must be provided at the time of application for a permit.

26 January 1983

M/s McDowell Williamson
P O Box 1134
ROTORUA

Dear Sirs

re: N.W. and M.A. HAYES' PROPERTY
LOT 39 DPS 17385, 45 JOANNE CRESCENT

This office holds a drainage application and permit issued on 15 June 1981 for the connecting of the above property to the district sewer scheme. It was applied for by a previous owner, Mr D. Sycamore, after receiving the normal reminder notice from Council stating that the statutory five year period for voluntary connecting to the sewer was approaching.

The permit issued at that time has now expired. The connection fee which was required at that date was also paid, a total of fifty dollars (\$50.00). As no action was undertaken during the six months allowable under the permit issued, a further permit must be applied for, plus an additional amount of eighty dollars (\$80.00) is required to increase the connection fee to its current cost of one hundred and thirty dollars (\$130.00).

As a permit had been issued for the connecting of the property to the sewer, no legal requisition was served on the owner at the five (5) year period.

As agent for the above property, would you at your earliest convenience contact the present owners and arrange for the necessary permit and extra connection fee to be paid allowing your nominated registered drainlayer to carry out the work necessary to connect the dwelling to the sewer, thereby complying with Council's policy.

If you require any further information please do not hesitate to contact the writer.

Yours faithfully

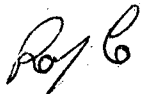

R.C. Goldsworthy
SENIOR PLUMBING AND
DRAINAGE INSPECTOR

5 February 1982

Mr D. Sycamore
46 Joanne Crescent
ROTORUA

Dear Sir

re: SEWER CONNECTION LOT 39 DPS 17385

On 15 June 1981 you paid \$50.00 for sewer connection fee for the above property.

At the same time as you paid this fee you also paid a permit fee and nominated a drainlayer to undertake the work.

According to our records although the permit has been issued the contractor nominated by you has not called upon this office to inspect the work, therefore we can only assume that the connection has not been made.

If this is in fact correct technically the permit issued has now expired.

Council policy is that if the connection is not undertaken within six months of the connection fee being paid and there has been an increase in connection fee in the interim, the property owner may be requested to pay the additional fee. Please note that the connection fee is now \$100.00

Council, however, will not charge the additional fee if the connection is completed by 28 February 1982.

Yours faithfully

G.N. Fraser
DISTRICT INSPECTOR

Plans MUST show dimensions and distances from section boundaries in metric units

Rotorua District Council

DRAINAGE PLAN

NEW SEWERAGE DRAINS — RED
STORMWATER — DOTTED BLACK
OLD DRAINS — FULL BLACK

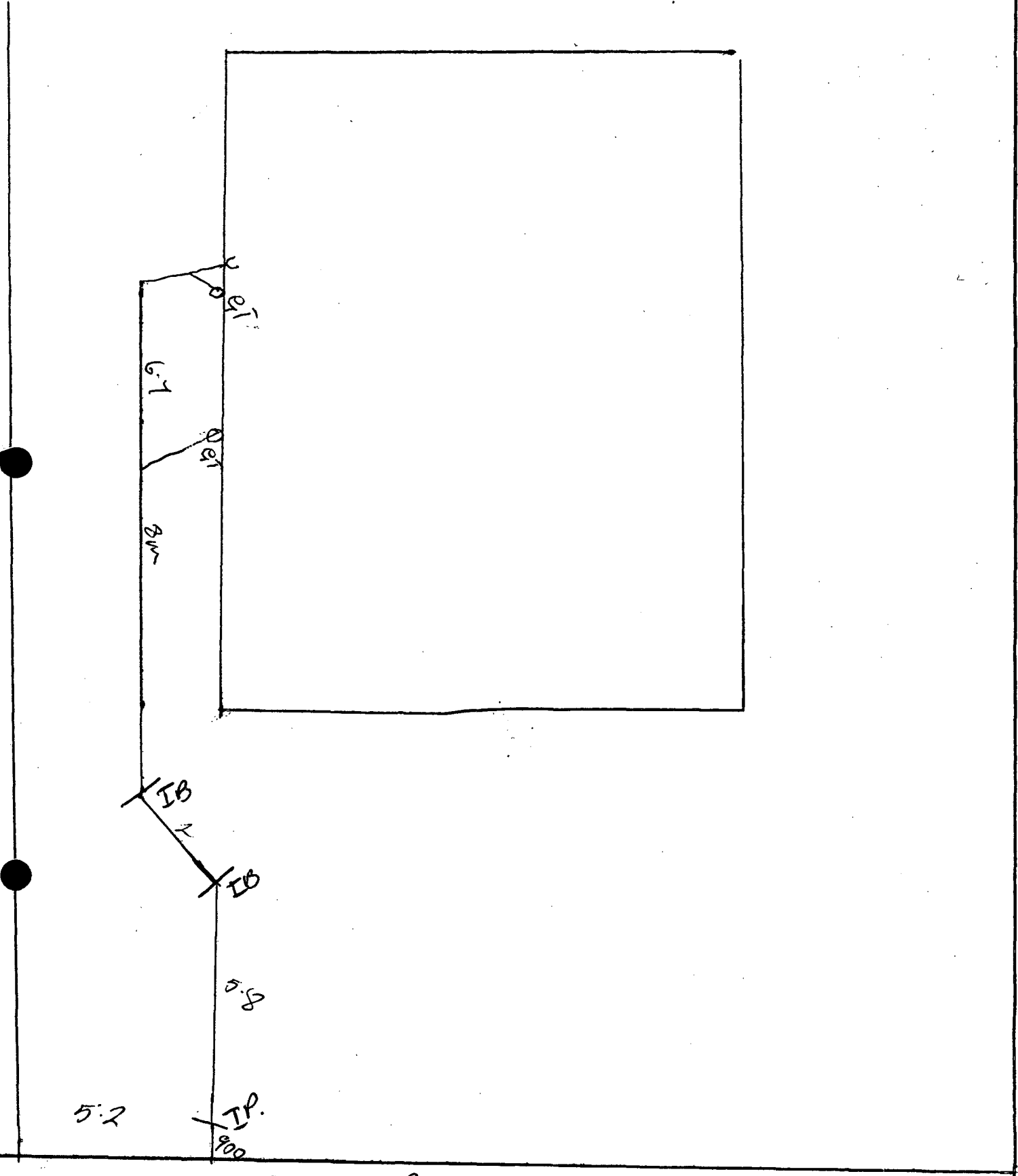

OWNER Mrs Hayes LOT SEC. BL.
No. 45 STREET Joanne Cr. SIGNATURE Lyndon OF DRAINLAYER DATE 22/3/83